

# Top Bend Tube

Pure Silicone Neon Flex Tube >>>

## T0511

SIZE  
11x5mm

APPLY  
PCB-8mm



## T0513

SIZE  
13x5mm

APPLY  
PCB-8-10mm

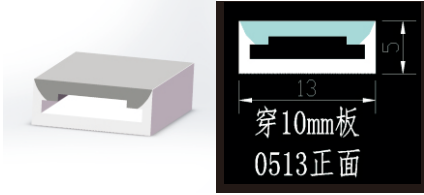

## T0807

SIZE  
8x7mm

APPLY  
PCB-5mm



## T1010

SIZE  
10x10mm

APPLY  
PCB-5mm



## T1010c

SIZE  
10x10mm

APPLY  
PCB-5mm



## T1212

SIZE  
12x12mm

APPLY  
PCB-5-8mm



## T1212c

SIZE  
12x12mm

APPLY  
PCB-5-8mm



## T1414

SIZE  
14x14mm

APPLY  
PCB-8-10mm



## T1414c

SIZE  
14x14mm

APPLY  
PCB-8-10mm



## T1616a

SIZE  
16x16mm

APPLY  
PCB-8-12mm



## T1616c

SIZE  
16x16mm

APPLY  
PCB-8-12mm



## T1616b

SIZE  
16x16mm

APPLY  
PCB-8-12mm

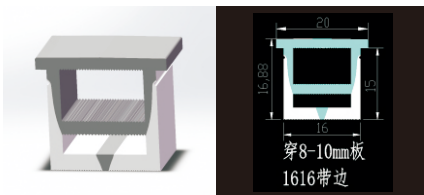

## T1510

SIZE  
15x10mm

APPLY  
PCB-8-10mm

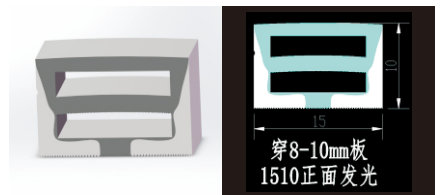

## T1817

SIZE  
18x17mm

APPLY  
PCB-10-12mm



## T2010

SIZE  
20x10mm

APPLY  
PCB-8-10mm



### T2014

SIZE  
20x14mm

APPLY  
PCB-8-12mm

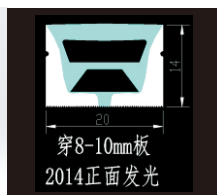

### T2014c

3 Side

SIZE  
20x14mm

APPLY  
PCB-8-12mm

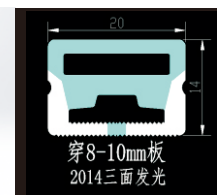

### T2014b

SIZE  
20x14mm

APPLY  
PCB-8-10mm

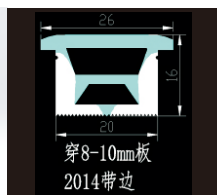

### T2517

SIZE  
25x17mm

APPLY  
PCB-10mm

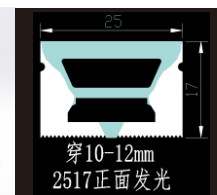

### T2020a

SIZE  
20x20mm

APPLY  
PCB-8-12mm

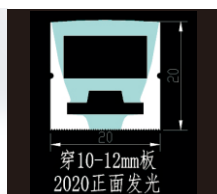

### T2020c

3 Side

SIZE  
20x20mm

APPLY  
PCB-8-12mm

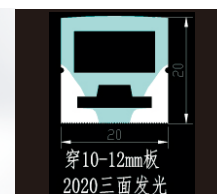
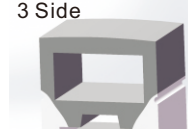

### T3020

SIZE  
30x20mm

APPLY  
PCB-10-15mm



### T3020c

3 Side

SIZE  
30x20mm

APPLY  
PCB-10-15mm

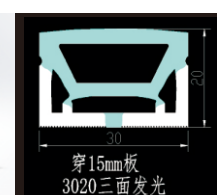

### T3020b

SIZE  
30x20mm

APPLY  
PCB-10-15mm

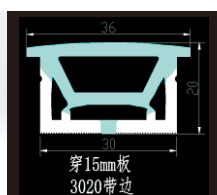

### T3014

SIZE  
30x14mm

APPLY  
PCB-10-15mm

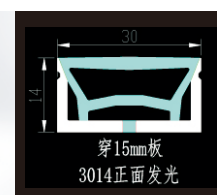

### T4025

SIZE  
40x25mm

APPLY  
PCB-15mm

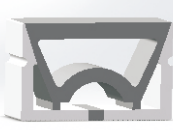

### T4025b

SIZE  
40x25mm

APPLY  
PCB-15mm

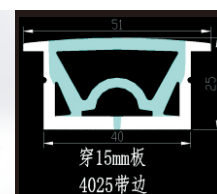

### T5015

SIZE  
50x15mm

APPLY  
PCB-8-12mm\*2pcs

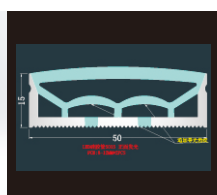
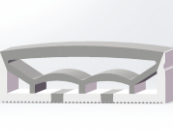

### T4020

SIZE  
40x20mm

APPLY  
PCB-15mm

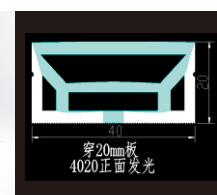
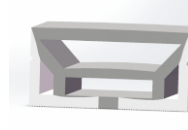

### T5020

SIZE  
50x15mm

APPLY  
PCB-15-20mm

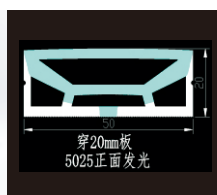
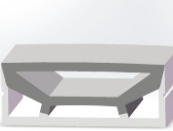

### T6030

SIZE  
60x30mm

APPLY  
PCB-20-30mm

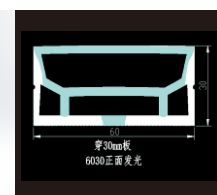
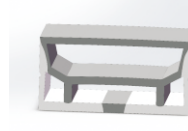

### T5025

SIZE  
50x25mm  
APPLY  
PCB-15-20mm

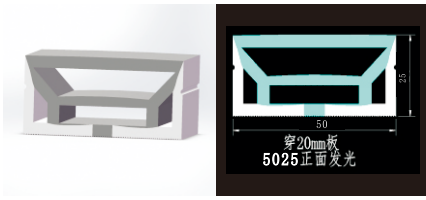

### T5025

SIZE  
50x25mm  
APPLY  
PCB-8-10mm\*2pcs

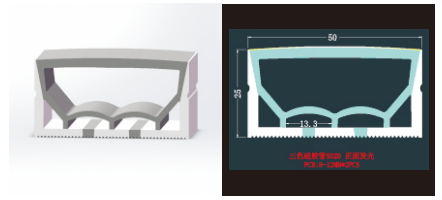

### T7030

SIZE  
70x30mm  
APPLY  
PCB-30mm



### T7030

SIZE  
70x30mm  
APPLY  
PCB-8-10mm\*3pcs

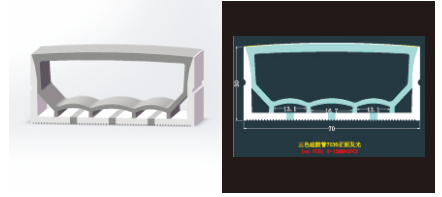

### T8030

SIZE  
80x30mm  
APPLY  
PCB-8-12mm\*3pcs

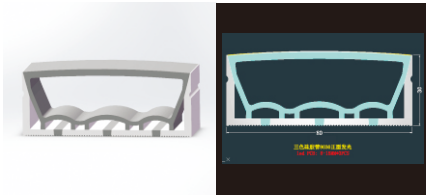

### T10030

SIZE  
100x30mm  
APPLY  
PCB-20mm\*2pcs

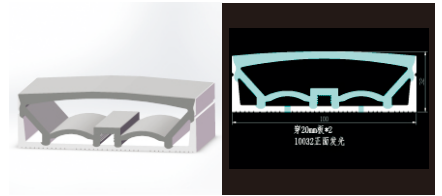

## Cover

### Pure Silicone Neon Flex Cover (no bottom)

### C1010

SIZE  
10x10mm  
APPLY  
PCB-5-8mm

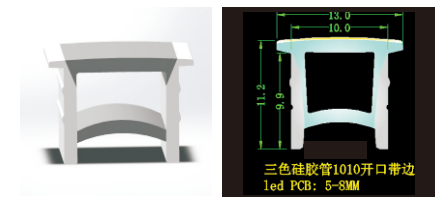

### C1212

SIZE  
12x12mm  
APPLY  
PCB-5-8mm

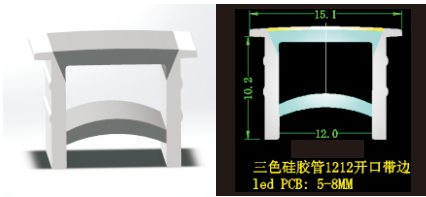

### C1414

SIZE  
14x14mm  
APPLY  
PCB-8-10mm

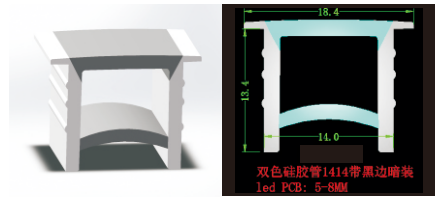

### C1510

SIZE  
15x10mm  
APPLY  
PCB-8-10mm

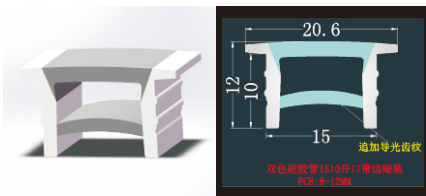

### C1520

SIZE  
15x20mm  
APPLY  
PCB-8-12mm

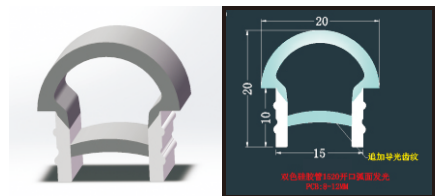

### C1616

SIZE  
16x16mm  
APPLY  
PCB-8-12mm

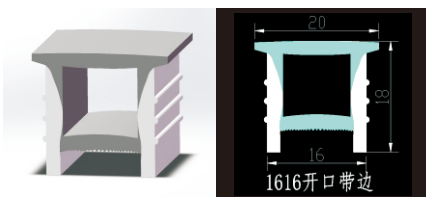

### C1616c

3 Side

SIZE  
16x16mm  
APPLY  
PCB-8-12mm



### C2014

SIZE  
20x14mm  
APPLY  
PCB-8-12mm

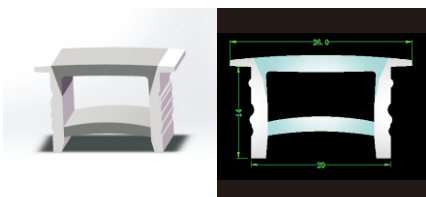

### C2010

SIZE  
20x10mm  
APPLY  
PCB-8-12mm

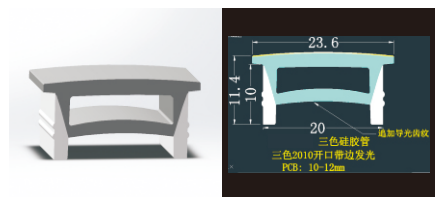

### C2020a

SIZE  
20x20mm  
APPLY  
PCB-8-12mm

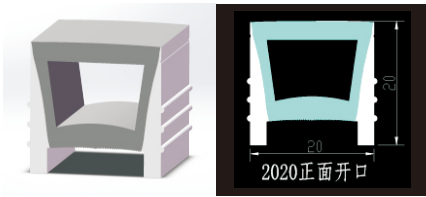

### C2020b

SIZE  
20x20mm  
APPLY  
PCB-8-12mm

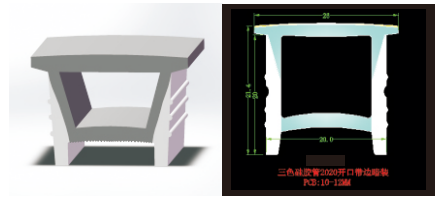

### C2520

SIZE  
25x20mm  
APPLY  
PCB-8-12mm

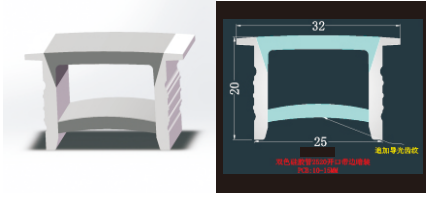

### C3010

SIZE  
30x10mm  
APPLY  
PCB-8-15mm

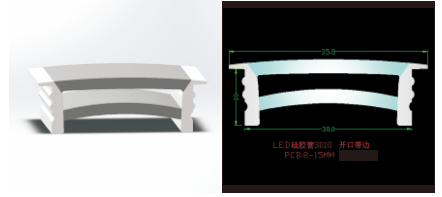

### C3020

SIZE  
30x20mm  
APPLY  
PCB-8-15mm

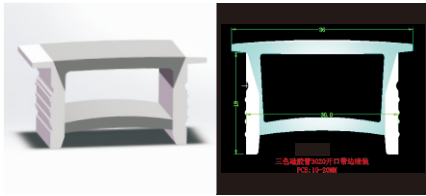

### C3025

SIZE  
30x25mm  
APPLY  
PCB-8-15mm

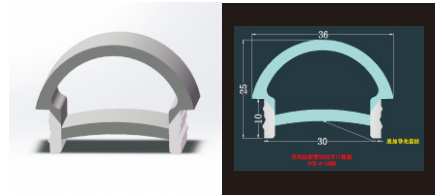

### C4020

SIZE  
40x20mm  
APPLY  
PCB-10-20mm

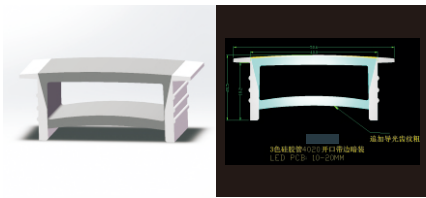

### C5020

SIZE  
50x20mm  
APPLY  
PCB-10-20mm

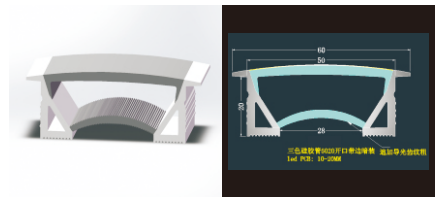

### C7030

SIZE  
70x30mm  
APPLY  
PCB-10-30mm

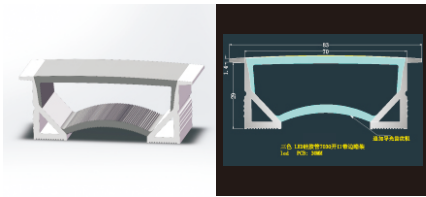

### C2023

SIZE  
20x23mm  
APPLY  
PCB-8-12mm

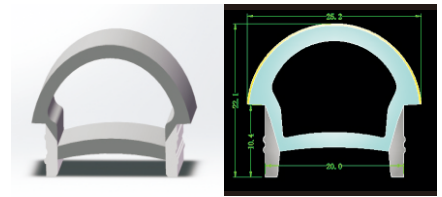

# Side Bend Tube

## Pure Silicone Neon Flex Tube

### S0612

SIZE  
6x12mm  
APPLY  
PCB-5-8mm



### S0410

SIZE  
4x10mm  
APPLY  
PCB-5mm

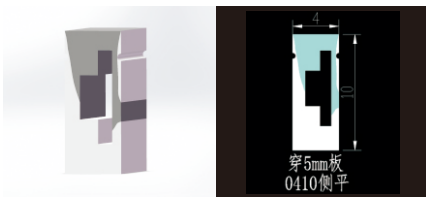

### S0615

SIZE  
6x15mm  
APPLY  
PCB-4-5mm

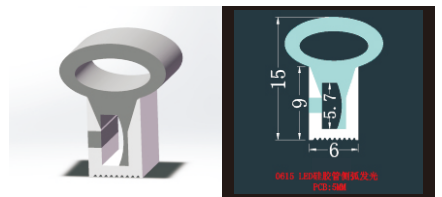

### S0613

SIZE  
6x13mm  
APPLY  
PCB-5-8mm



### S0817f

SIZE  
8x17mm  
APPLY  
PCB-8mm



### S0811

SIZE  
8x11mm

APPLY  
PCB-5-8mm

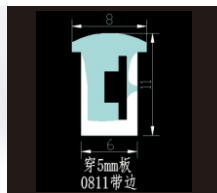

### S1015

SIZE  
10x15mm

APPLY  
PCB-8mm



### S0817r

SIZE  
8x17mm

APPLY  
PCB-8mm



### S1020

SIZE  
10x20mm

APPLY  
PCB-10mm

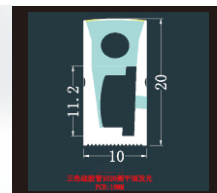

### S1018

SIZE  
10x18mm

APPLY  
PCB-8-10mm



### S1115

SIZE  
11x15mm

APPLY  
PCB-8-10mm

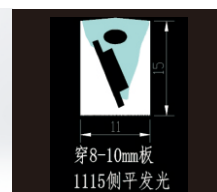

### S1023

SIZE  
10x23mm

APPLY  
PCB-10mm



### S1220

SIZE  
12x20mm

APPLY  
PCB-10-12mm



### S1212

SIZE  
12x12mm

APPLY  
PCB-5mm



### S1525

SIZE  
15x25mm

APPLY  
PCB-12mm

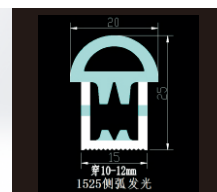

### S1225

SIZE  
12x25mm

APPLY  
PCB-10-12mm



### S1616-2

SIZE  
16x16mm

APPLY  
PCB-8-10mm

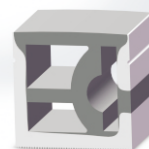

### St2020

side+top bend 2in1

SIZE  
20x20mm

APPLY  
PCB-10-12mm

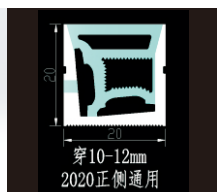
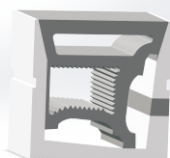

### S2020

SIZE  
20x20mm

APPLY  
PCB-10-12mm

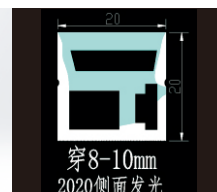

### S2032

SIZE  
20x32mm

APPLY  
PCB-10mm



### S3030

SIZE  
30x30mm

APPLY  
PCB-10-12mm

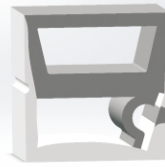

# 3045

SIZE  
30x45mm  
APPLY  
PCB-10mm

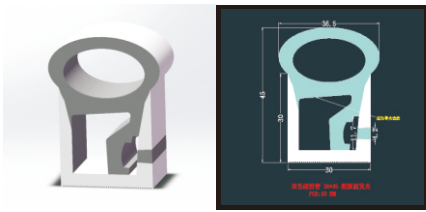

# V1616

right-angle

SIZE  
16x16mm  
APPLY  
PCB-8-10mm

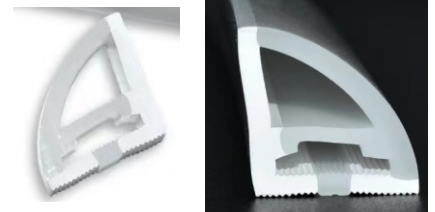

# Tr1313

SIZE  
13x13mm  
APPLY  
PCB-5-8mm



# Others

## Pure Silicone Neon Flex Tube

# T3020-floor

step on ground

SIZE  
30x20mm  
APPLY  
PCB-10-15mm



# Tr1513

SIZE  
15x13mm  
APPLY  
PCB-8-10mm

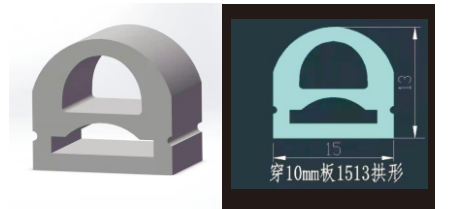

# T4020-floor

step on ground

SIZE  
40x20mm  
APPLY  
PCB-15-20mm

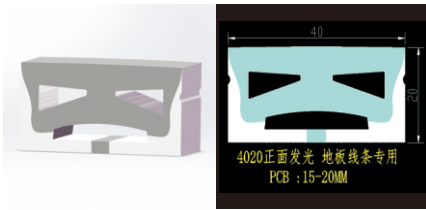

# D13-360

SIZE  
D13mm\*360°  
APPLY  
PCB-5mm double lit led



# D13-270

SIZE  
D13mm\*270°  
APPLY  
PCB-5mm



# D16-270

SIZE  
D16mm\*270°  
APPLY  
PCB-8mm



# D20-270

SIZE  
D20mm\*270°  
APPLY  
PCB-10mm



# D22-360

SIZE  
D22mm\*360°  
APPLY  
PCB-5mm double lit led

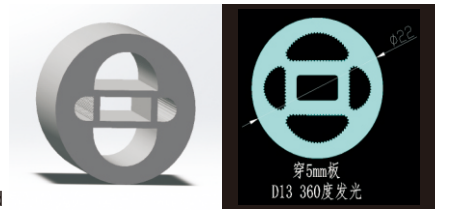

# D24-360

SIZE  
D24mm\*360°  
APPLY  
PCB-8-10mm double lit led



# V22

SIZE  
22x13mm  
APPLY  
PCB-5mm



# Installation Accessories

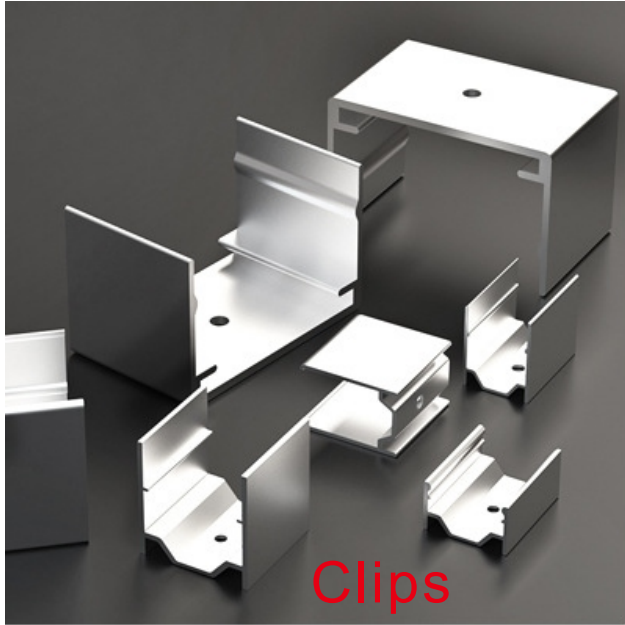

Clips



1m Rigid Channel

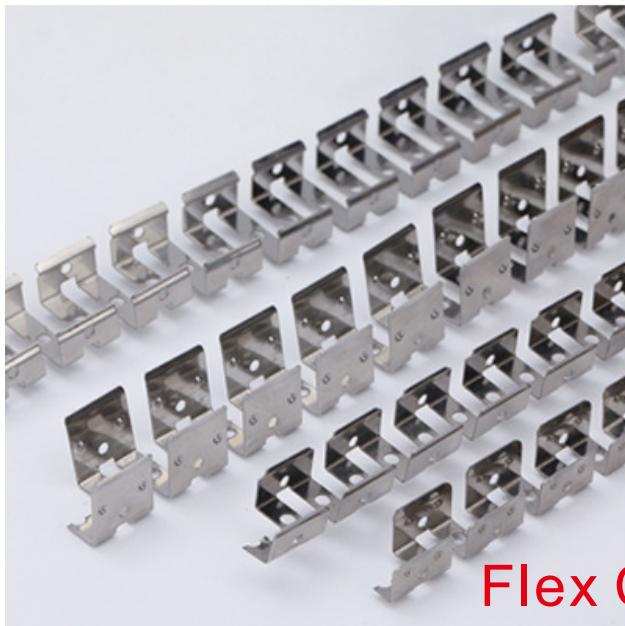

Flex Channel

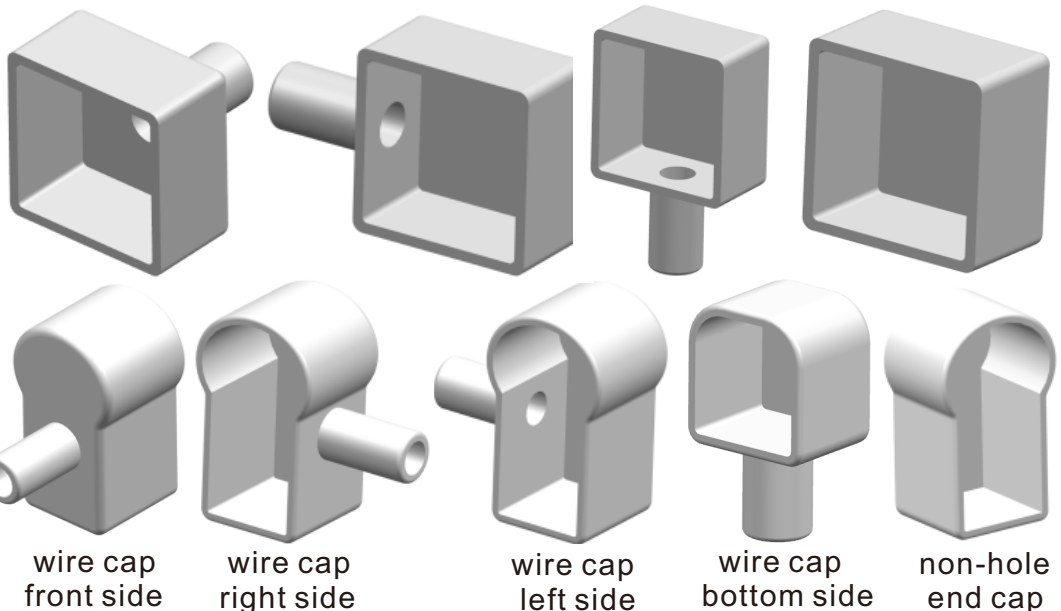
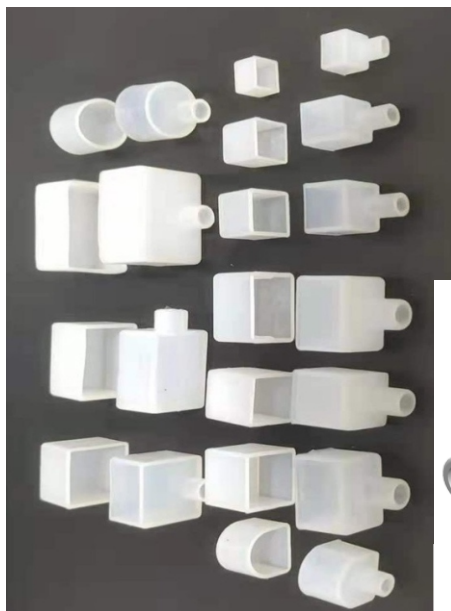

wire cap front side

wire cap right side

wire cap left side

wire cap bottom side

non-hole end cap